

## *Adaptive Medical Products*



Wheelchair trays are designed to provide upper extremity support and assist in everyday tasks allowing wheelchair users to be more active in their everyday lives.

The following pages contain information designed to help in ordering the correct tray and mounting hardware for your application. Standard, custom trays and all mounting hardware may be quoted and ordered by printing the "Standard Tray Quote/Order Form", or the "Custom Tray Quote/Order Form" and faxing the form to 859-261-5488. Hardware may be ordered separately online, by accessing the "Tray Mounting Hardware" tab.

Generous discounts apply to quantity purchases, we are eager to structure a program specific to your needs that may save you money. Call us at 1-800-964-3338, we look forward to working with you.

Adaptive Medical Products

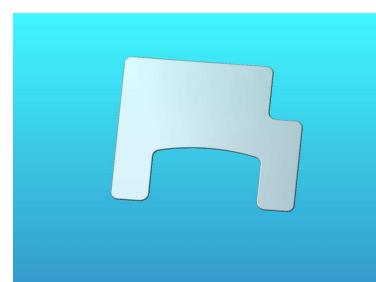

# Table of Contents

## Pages

3	Standard Tray Quote/Order Form
4-5	Custom Tray Design Quote/Order Form
6-26	Standard Tray Dimensions

Adaptive Medical Products  
677 W 3d St  
Covington, Ky 41011

Fax 1-800-964-3338  
859-261-5488  
[www.adaptmed.com](http://www.adaptmed.com)

## Standard Tray Quote & Order Form

Co Name	PO #	Quote #	Date
Co Address	Co Phone #		
Co Contact/Instructions	Co Fax #		

Use the corresponding letters to receive a quote or order a standard tray. Letters correspond to material, tray size, stomach and joystick cutout. Recommended chair frame sizes are noted, for a complete dimensional description of each standard tray, refer to our "Standard Tray Dimensions" pages. Refer to our "Custom Tray Order Form" to design a custom tray.

Example: Medium Tray, Round Stomach Cutout, Right Joystick Cutout, Wood = Tray MRJR-W  
 Extra Small Tray, Square Cutout, no joystick cutout, Polycarbonate = Tray ESS-P

<u>Letter</u>	<u>Tray Size (chair size)</u>	<u>Letter</u>	<u>Cutout Description</u>	<u>Letter</u>	<u>Material</u>
ES	Extra Small (11"-12")	R	Round Stomach Cutout	-P	Polycarbonate
S	Small (13"-14")	S	Square Stomach Cutout	-W	Wood
M	Medium (15"-16")	JR	Right Joystick Cutout	-A	Acrylic
L	Large (17"-18")	JL	Left Joystick Cutout		
EL	Extra Large (19"-20")				
HT	Half Tray (all)				

Standard Tray Letters \_\_\_\_\_ Qty \_\_\_\_\_  
 \_\_\_\_\_

Custom Logo: Customer logo's can be added to standard trays at additional cost. Contact us for details.  
 Other Materials: Trays can be produced from other materials, contact us with your material preferences.

Trays are provided without mounting hardware and rim, choose from the following mounting and attachment options:

<u>P/N</u>	<u>Description</u>	<u>Qty</u>	<u>Suggested Retail</u>	<u>P/N</u>	<u>Description</u>	<u>Qty</u>	<u>Suggested Retail</u>
KH	Knob Hardware	___	\$ 25.50	Z-Slide1.000B	Z-Slides 1 Clearance	___	\$33.00
TC	Toggle Clamps	___	\$ 33.00	Z-Slide 1.250B	Z-Slides 1 <sup>1/4</sup> Clearance	___	\$33.00
VC	Velcro Strap	___	\$ 15.00	Z-Slide1.500B	Z-Slides 1 <sup>1/2</sup> Clearance	___	\$33.00
TS	Tray Strap	___	\$ 30.00	FC1.125B	Full Channel 1 <sup>1/8</sup> Height	___	\$45.00
R	Rim	___	\$ 15.00	FC1.125B-H	Full Channel 1 <sup>1/8</sup> /Hinge Mtg	___	\$75.00
				FC 1.250B	Full Channel 1 <sup>1/4</sup> Height	___	\$45.00
				FC 1.250B-H	Full Channel 1 <sup>1/4</sup> /Hinge Mtg	___	\$75.00



## Custom Tray Design & Quote Order Form

### Square Stomach Cutout

Date \_\_\_\_\_

Company Name \_\_\_\_\_ PO# \_\_\_\_\_

Quote # \_\_\_\_\_

Contact Person \_\_\_\_\_ Phone # \_\_\_\_\_

Fax # \_\_\_\_\_

Square Stomach Cutout

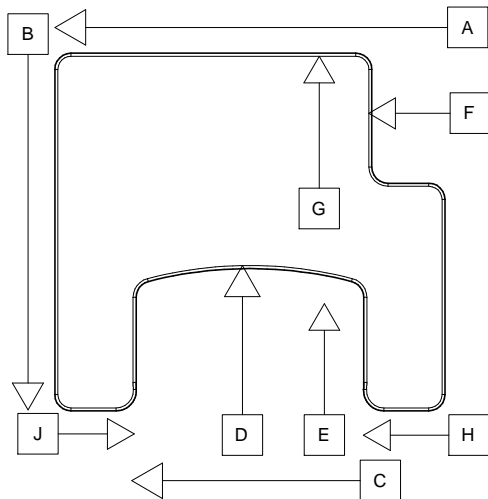

Use the corresponding letters to design, receive a quote or order a custom tray. Add any additional dimensions or requirements you may have to the design.

A= \_\_\_\_\_ E= \_\_\_\_\_

B= \_\_\_\_\_ F= \_\_\_\_\_ (R,L)

C= \_\_\_\_\_ G= \_\_\_\_\_ (R,L)

D= \_\_\_\_\_ H= \_\_\_\_\_

J= \_\_\_\_\_

Note: If specifying joystick cutout (F&G), specify right (R) or left (L) cutout after the dimensions. (Right hand cutout shown)

Additional Requirements or Info:

Material:

Custom Logo  
(Customer Supplied file)

Other:

All custom trays are individually quoted and are provided without rim and mounting hardware. Choose from the following mounting and attachment options:

P/N	Description	QTY
KH	Knob Hardware	___
ZSlides1.000B	Z-Slides 1" Clearance	___
ZSlides1.250B	Z-Slides 1.250" Clearance	___
ZSlides1.500B	Z-Slides 1.500" Clearance	___
TC	Toggle Clamps	___
VC	Velcro Straps	___
TS	Tray Straps	___
R	Rim	___



Custom Tray Design & Quote Order Form  
Round Stomach Cutout

Date \_\_\_\_\_

Company Name \_\_\_\_\_ PO # \_\_\_\_\_ Quote # \_\_\_\_\_

Contact Person \_\_\_\_\_ Phone# \_\_\_\_\_

Fax # \_\_\_\_\_

Round Stomach Cutout

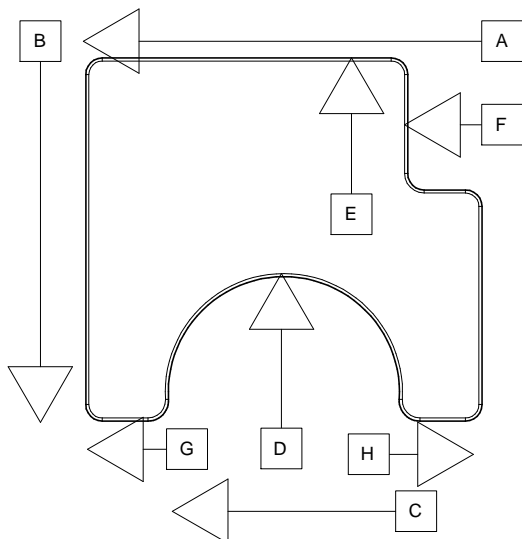

Use the corresponding letters to design, receive a quote or order a custom tray. Add any additional dimensions or requirements you may have to the design

A= \_\_\_\_\_ E= \_\_\_\_\_ (R,L)

B= \_\_\_\_\_ F= \_\_\_\_\_ (R,L)

C= \_\_\_\_\_ G= \_\_\_\_\_

D= \_\_\_\_\_ H = \_\_\_\_\_

Note: If specifying joystick cutout (E & F), specify right (R) or left (L) cutout after the dimensions. (Right hand cutout shown.)

Additional Requirements or Info:

Material:

Custom Logo  
(Customer Supplied file)

Other:

All custom trays are individually quoted and are provided without rim and mounting hardware. Choose from the following mounting and attachment options:

<u>P/N</u>	<u>Description</u>	<u>QTY</u>
KH	Knob Hardware	___
ZSlides1.000B	Z-Slides 1" Clearance	___
ZSlides1.250B	Z-Slides 1.250" Clearance	___
ZSlides1.500B	Z-Slides 1.500" Clearance	___
TC	Toggle Clamps	___
VC	Velcro Straps	___
TS	Tray Straps	___
R	Rim	___

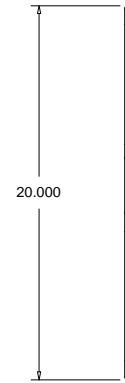
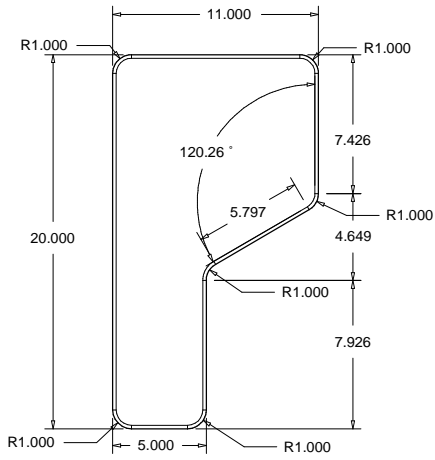
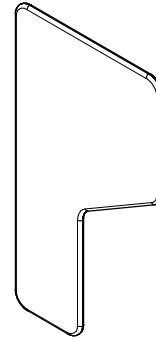
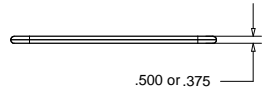

Adaptive Medical Products  
677 W 3d St  
Covington, Ky 41011  
1-800-964-3338  
www.adaptmed.com

Half Tray  
Part # HT

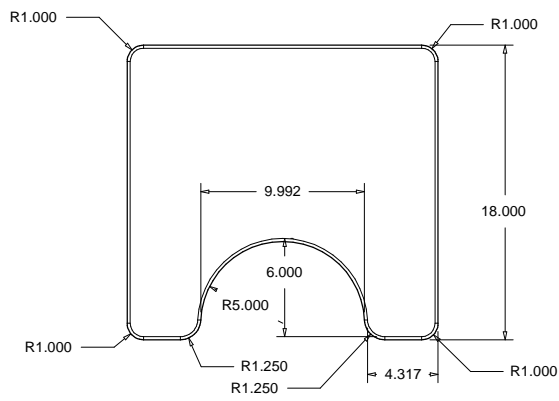
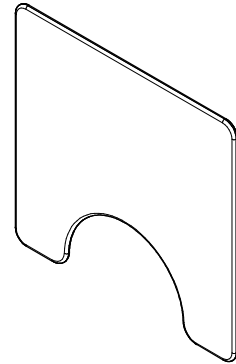
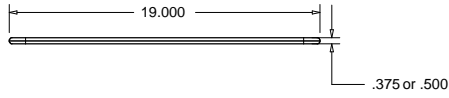

Adaptive Medical Products  
677 W 3d St  
Covington, Ky 41011  
1-800-964-3338  
www.adaptmed.com

Extra Small Round Cutout Tray  
Part # -ESR

Recommended Frame Size - 11", 12"

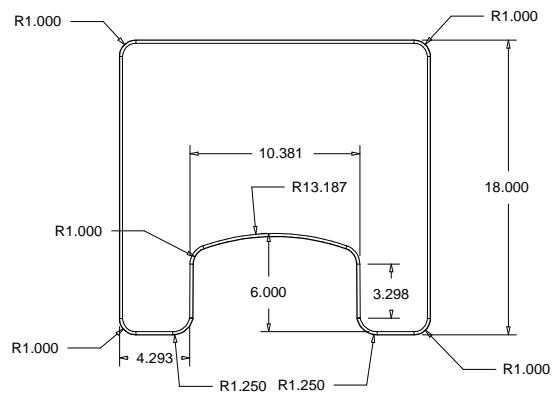
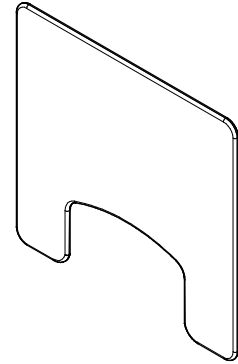
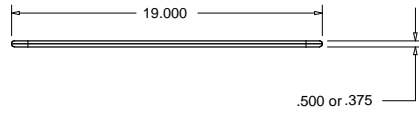

Extra Small Square Cutout Tray  
Part # - ESS

Recommended Frame Size-11",12"

Adaptive Medical Products  
677 W 3d St  
Covington, Ky 41011  
1-800-964-3338  
www.adaptmed.com



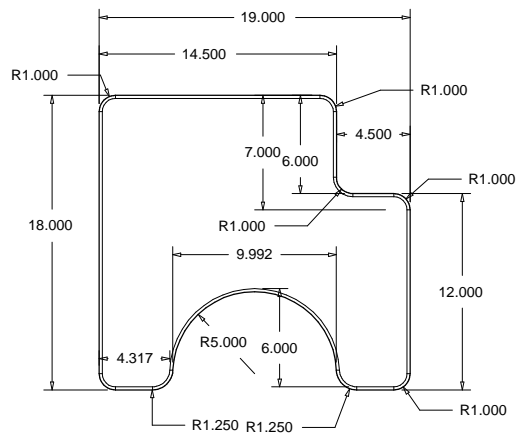
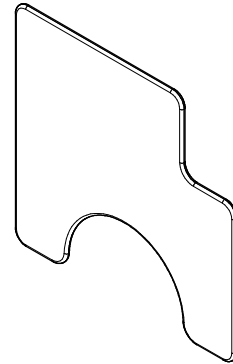
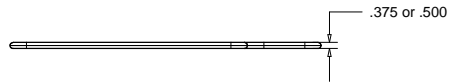

Extra Small Round, Joystick Cutout Tray  
Part # -ESRJR (Right Hand)  
ESR JL (Left Hand)

Recommended Frame Size-11", 12"

Adaptive Medical Products  
677 W 3d St  
Covington, Ky 41011  
1-800-964-3338  
www.adaptmed.com

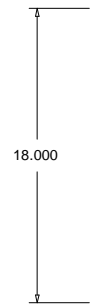
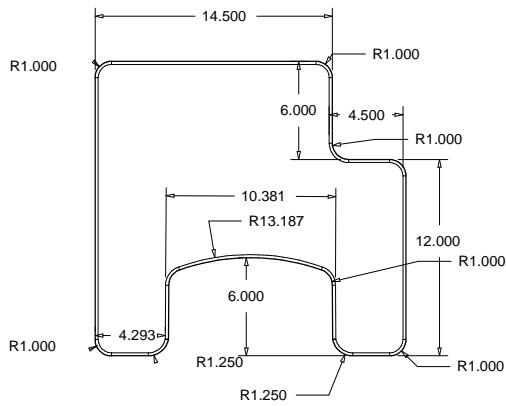
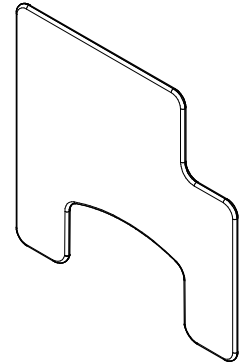
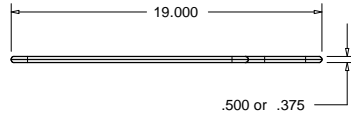

Extra Small Square, Joystick Cutout Tray  
Part # - ESSJR ( Right Hand)  
ESSJL ( Left Hand)  
Recommended Frame Size- 11",12"

Adaptive Medical Products  
677 W 3d St  
Covington, Ky 41011  
1-800-964-3338  
Fax 1-859-261-5488  
www.adaptmed.com

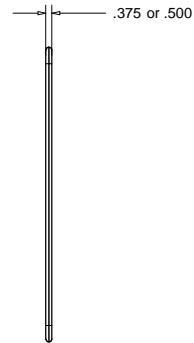
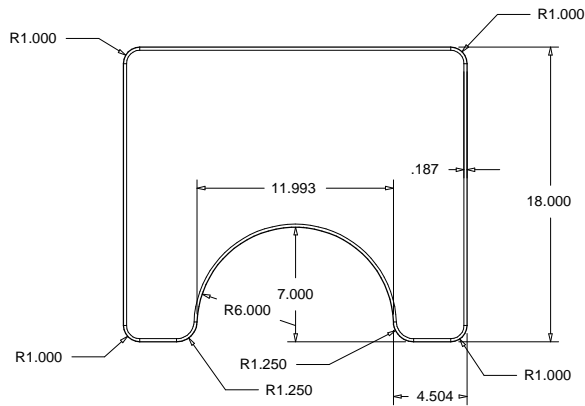
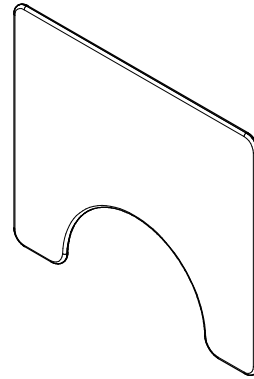
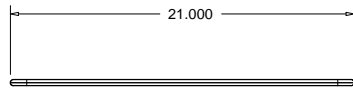

Adaptive Medical Products  
677 W 3rd St  
Covington, Ky 41011  
1-800-964-3338  
www.adaptmed.com

Small Round Cutout Tray  
Part # - SR  
Recommended Frame Size - 13", 14"

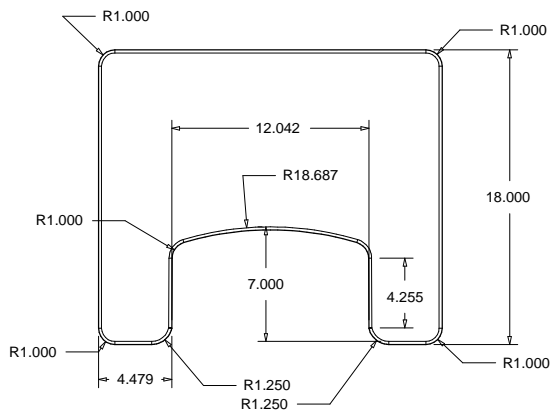
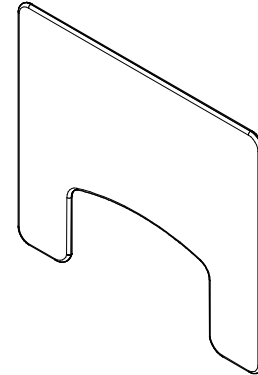
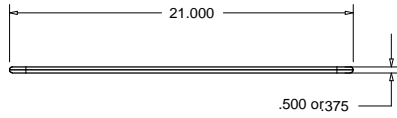

Small Square Cutout Tray  
Part # - SS

Recommended Frame Size- 13",14"

Adaptive Medical Products  
677 W 3d St  
Covington, Ky 41011  
1-800-964-3338  
www.adaptmed.com

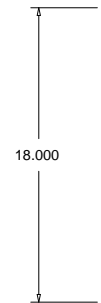
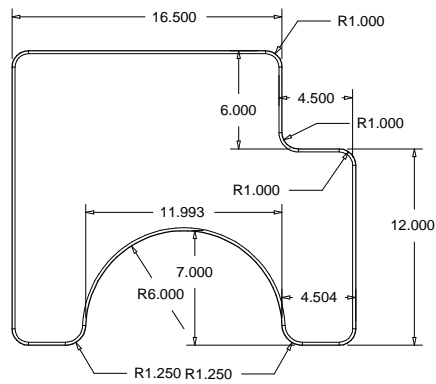
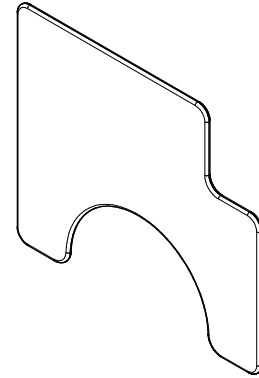
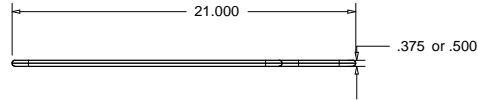

Adaptive Medical Products  
677 W 3d St  
Covington, Ky 41011  
1-800-964-3338  
www.adaptmed.com

Small Round Joystick Cutout Tray  
Part # - SRJR ( Right Hand)  
SRJL ( Left Hand)  
Recommended Frame Size - 13",14"

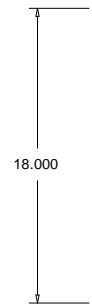
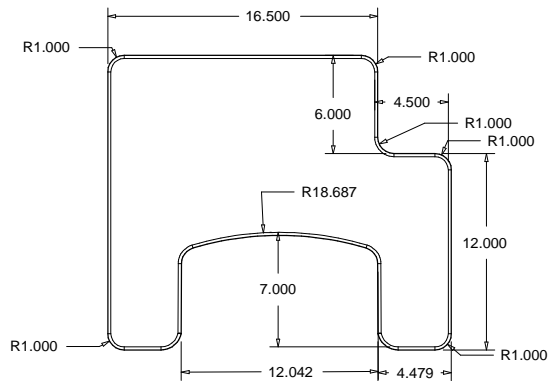
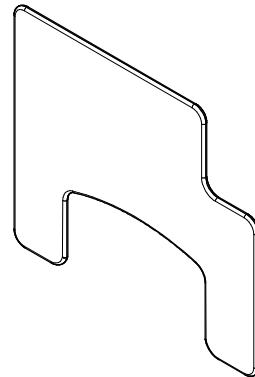
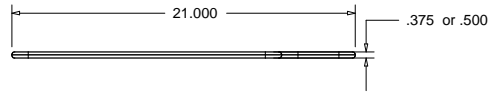

Adaptive Medical Products  
677 W 3d St  
Covington, Ky 41011  
1-800-964-3338  
www.adaptmed.com

Small Square Joystick Cutout Tray  
Part # - SSJR (Right Hand)  
SSJL (Left Hand)

Recommended Frame Size - 13", 14"

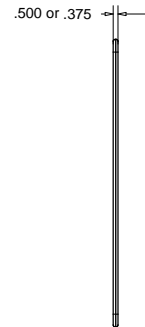
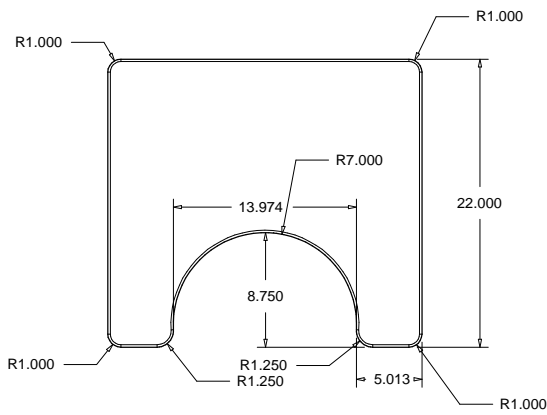
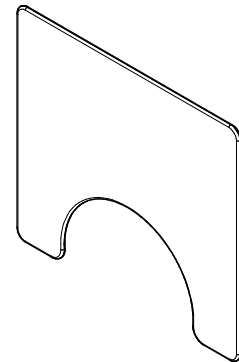
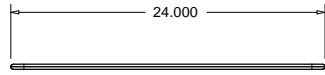

Adaptive Medical Products  
677 W 3d St  
Covington, Ky 41011  
1-800-964-3338  
www.adaptmed.com

Medium Round Cutout Tray  
Part # - MR  
Recommended Frame Size - 15",16"

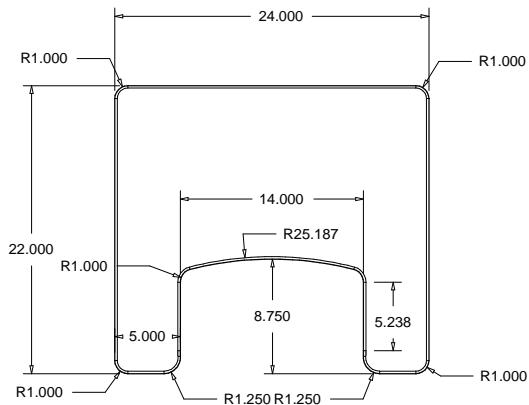
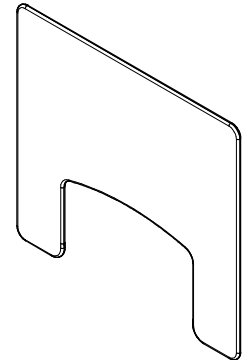

Medium Square Cutout Tray  
Part # -MS

Recommended Frame Size- 15",16"

Adaptive Medical Products  
677 W 3d St  
Covington, Ky 41011  
1-800-964-3338  
www.adaptmed.com



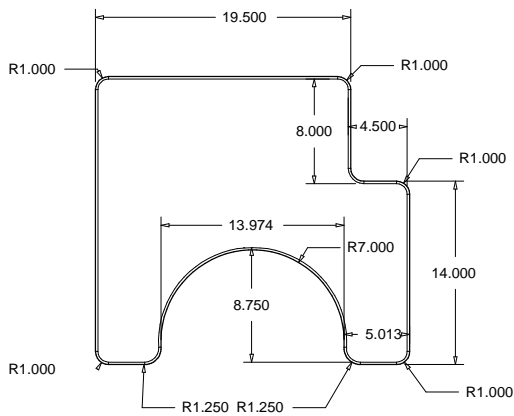
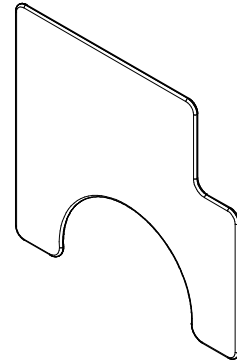
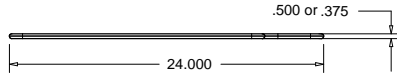

Medium Round Joystick Cutout Tray  
Part # - MRJR ( Right Hand)  
MRJL ( Left Hand)  
Recommended Frame Size - 15",16"

Adaptive Medical Products  
677 W 3d St  
Covington, Ky 41011  
1-800-964-3338  
www.adaptmed.com

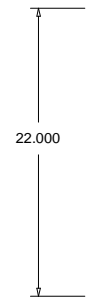
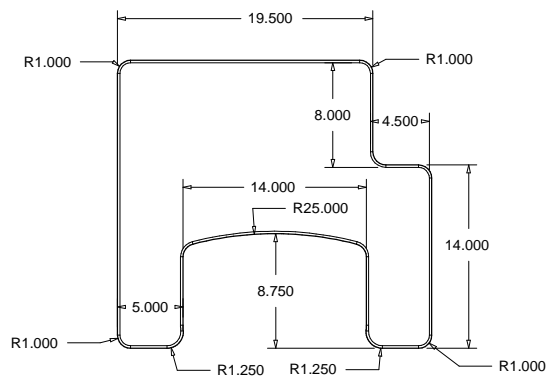
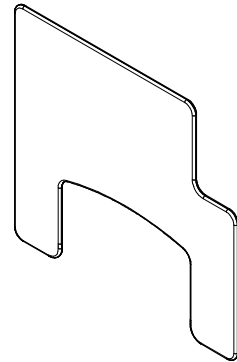
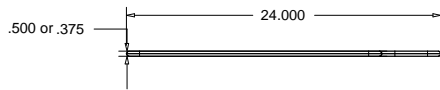

Adaptive Medical Products  
677 W 3d St  
Covington, Ky 41011  
1-800-964-3338  
www.adaptmed.com

Medium Square, Joystick Cutout Tray  
Part # -MSJR (Right Hand)  
MSJL ( Left Hand)

Recommended Frame Size - 15",16"

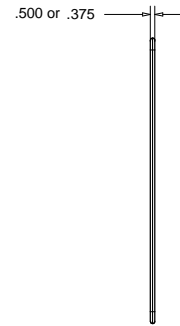
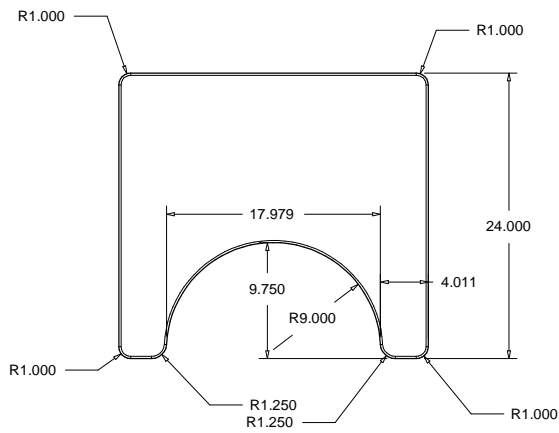
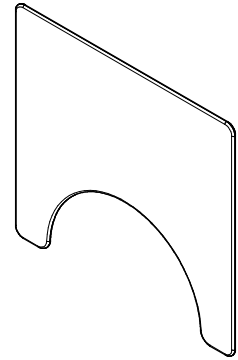
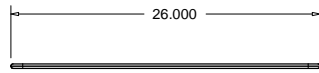

Adaptive Medical Products  
677 W 3d St  
Covington, Ky 41011  
1-800-964-3338  
www.adaptmed.com

Large Round Cutout Tray  
Part # - LR  
Recommended Frame Size - 17", 18"

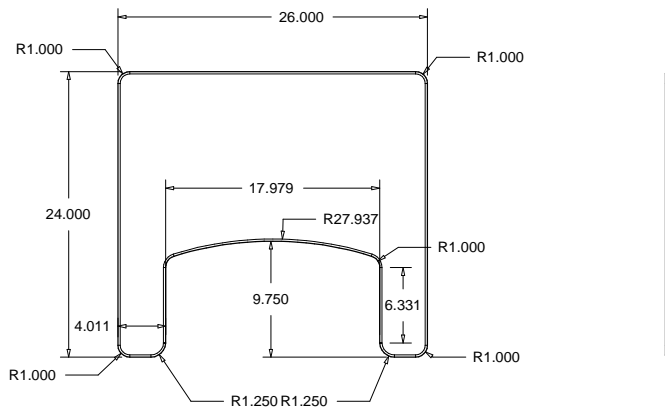
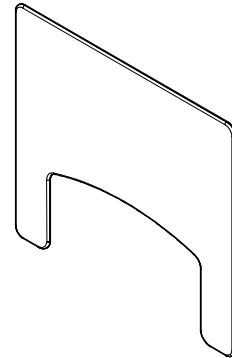

Large Square Cutout Tray  
Part # - LS

Recommended Frame Size- 17", 18"

Adaptive Medical Products  
677 W 3d St  
Covington, Ky 41011  
1-800-964-3338  
www.adaptmed.com

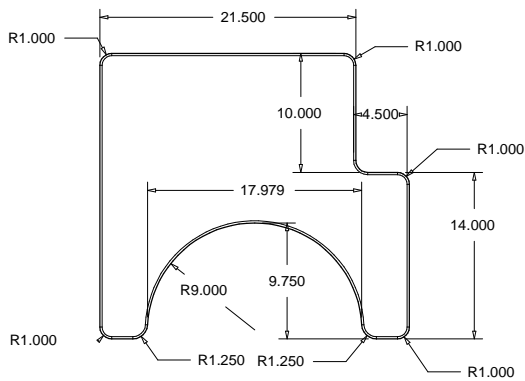
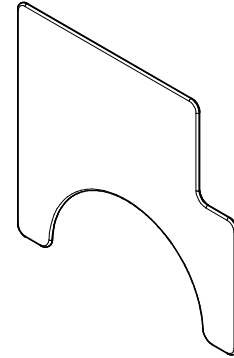
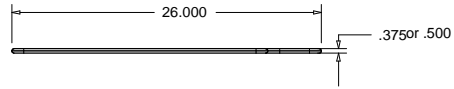

Adaptive Medical Products  
677 W 3d St  
Covington, Ky 41011  
1-800-964-3338  
www.adaptmed.com

Large Round Joystick Cutout Tray  
Part # - LRJR (Right Hand)  
LRJL ( Left Hand)

Recommended Frame Size -17",18"

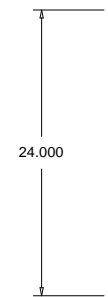
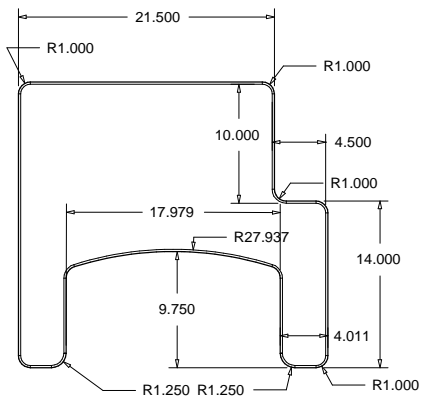
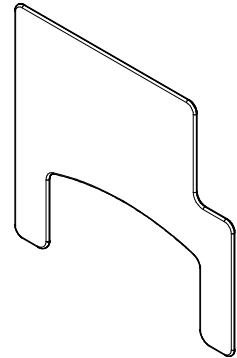
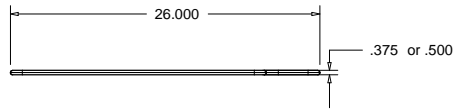

Large Square Joystick Cutout Tray  
Part # -LSJR (Right Hand)  
LSJL ( Left Hand)

Recommended Frame Size - 17",18"

Adaptive Medical Products  
677 W 3d St  
Covington, Ky 41011  
1-800-964-3338  
www.adaptmed.com

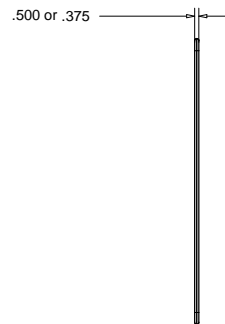
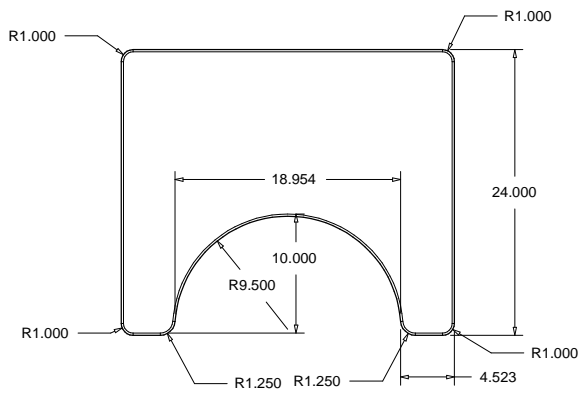
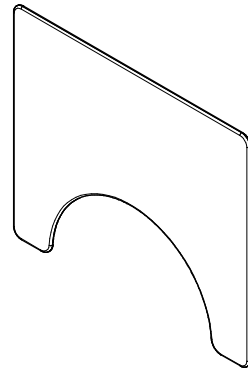
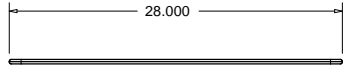

Extra Large Round Cutout Tray  
Part # -ELR

Recommended Frame Size-19",20"

Adaptive Medical Products  
677 W 3d St  
Covington, Ky 41011  
1-800-964-3338  
www.adaptmed.com

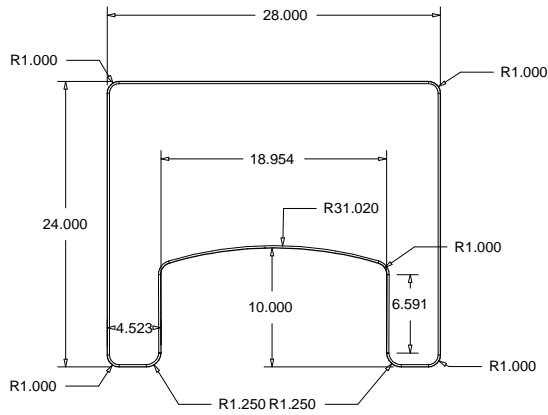
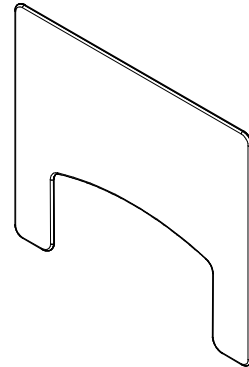

Extra Large Square Cutout Tray  
Part # -ELS

Recommended Frame Size- 19",20"

Adaptive Medical Products  
677 W 3d St  
Covington, Ky 41011  
1-800-964-3338  
www.adaptmed.com



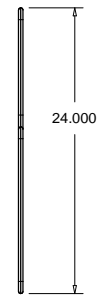
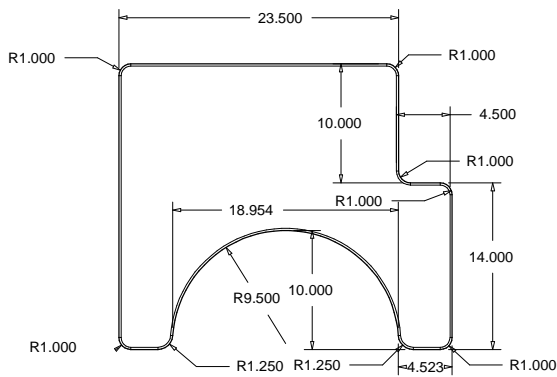
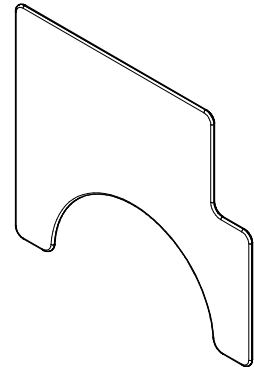
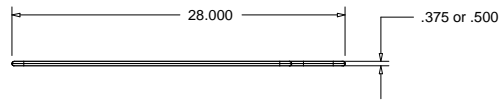

Extra Large Round Joystick Cutout Tray  
Part # -ELRJR (Right Hand)  
ELRJL ( Left Hand)

Recommended Frame Size-19",20"

Adaptive Medical Products  
677 W 3d St  
Covington, Ky 41011  
1-800-964-3338  
www.adaptmed.com

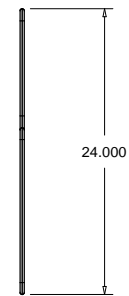
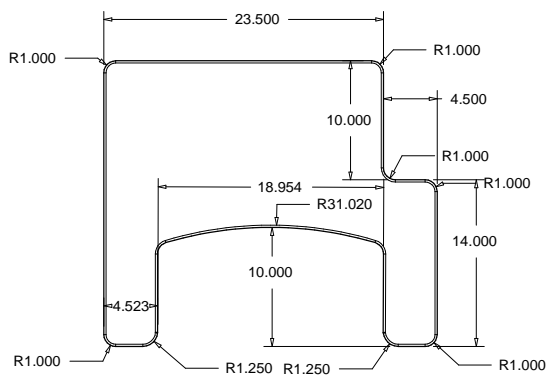
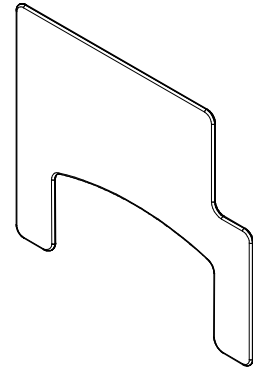
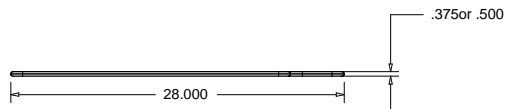

Adaptive Medical Products  
677 W 3d St  
Covington, Ky 41011  
1-800-964-3338  
www.adaptmed.com

Extra Large Square Joystick Cutout Tray  
Part # - ELSJR (Right Hand)  
ELSJL (Left Hand)

Recommended Frame Size - 19", 20"